



Chipping Norton, NSW

37 Derby Crescent

4 BED **3** BATH **2** CAR

RealEquity
estate agents

Spanning over 2 levels with an east facing position, this generous sized home is only around the corner from local shops and transport with easy access to the local park which is ideal for the children. Offered with plenty of living spaces and loads of natural light.

Features

- Formal lounge leading to separate dining area
- 4 large bedrooms, main with en suite
- Excellent kitchen with loads of bench space
- Separate rumpus room or optional 5th room
- Upstairs children's retreat area

\$895,000 - \$935,000

Contact: Anthony Prestia
02 9755 4222
0414 775 577
Joshua Prestia
02 9755 4222
0404 252 695

Type: House
Sold Date: 18/04/2019
Land: 561m2
<https://www.realequity.com.au>

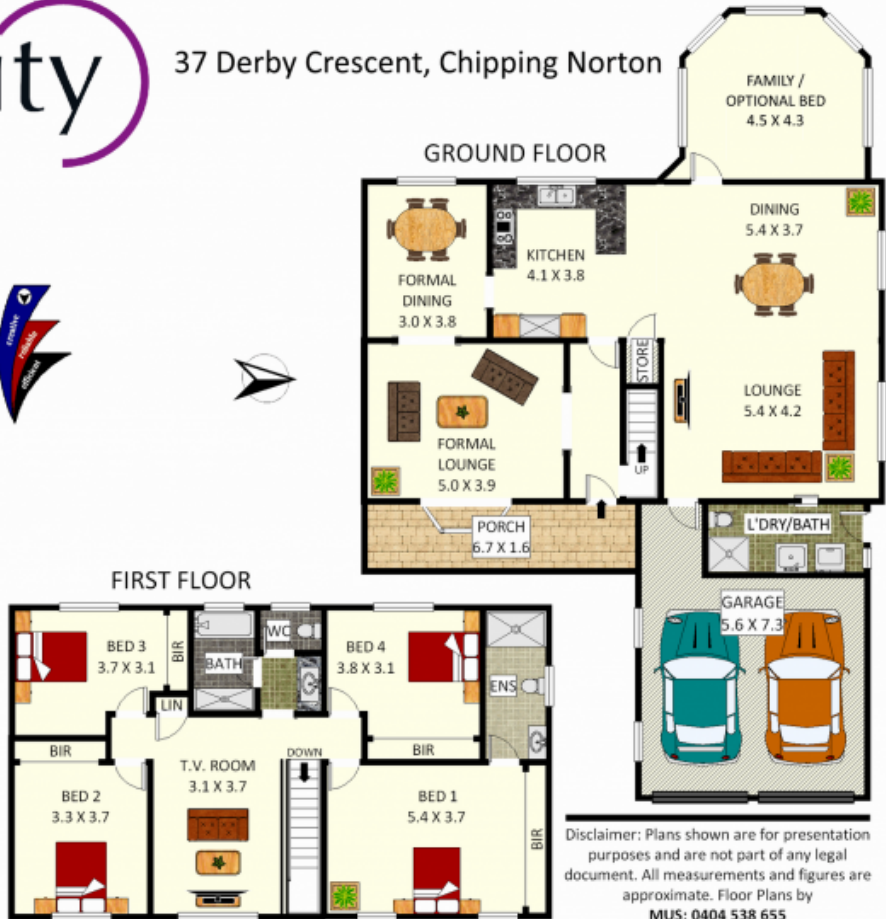

Disclaimer: Plans shown are for presentation purposes and are not part of any legal document. All measurements and figures are approximate. Floor Plans by MUS: 0404 538 655

Plans shown are only indicative of layout. Dimensions are approximate.