



## Chipping Norton, NSW

37 Derby Crescent

**4** BED **3** BATH **2** CAR

**RealEquity**  
estate agents

Spanning over 2 levels with an east facing position, this generous sized home is only around the corner from local shops and transport with easy access to the local park which is ideal for the children. Offered with plenty of living spaces and loads of natural light.

### Features

- Formal lounge leading to separate dining area
- 4 large bedrooms, main with en suite
- Excellent kitchen with loads of bench space
- Separate rumpus room or optional 5th room
- Upstairs children's retreat area

**\$895,000 - \$935,000**

**Contact:** Anthony Prestia  
02 9755 4222  
0414 775 577  
Joshua Prestia  
02 9755 4222  
0404 252 695

**Type:** House  
**Sold Date:** 18/04/2019  
**Land:** 561m2  
<https://www.realequity.com.au>

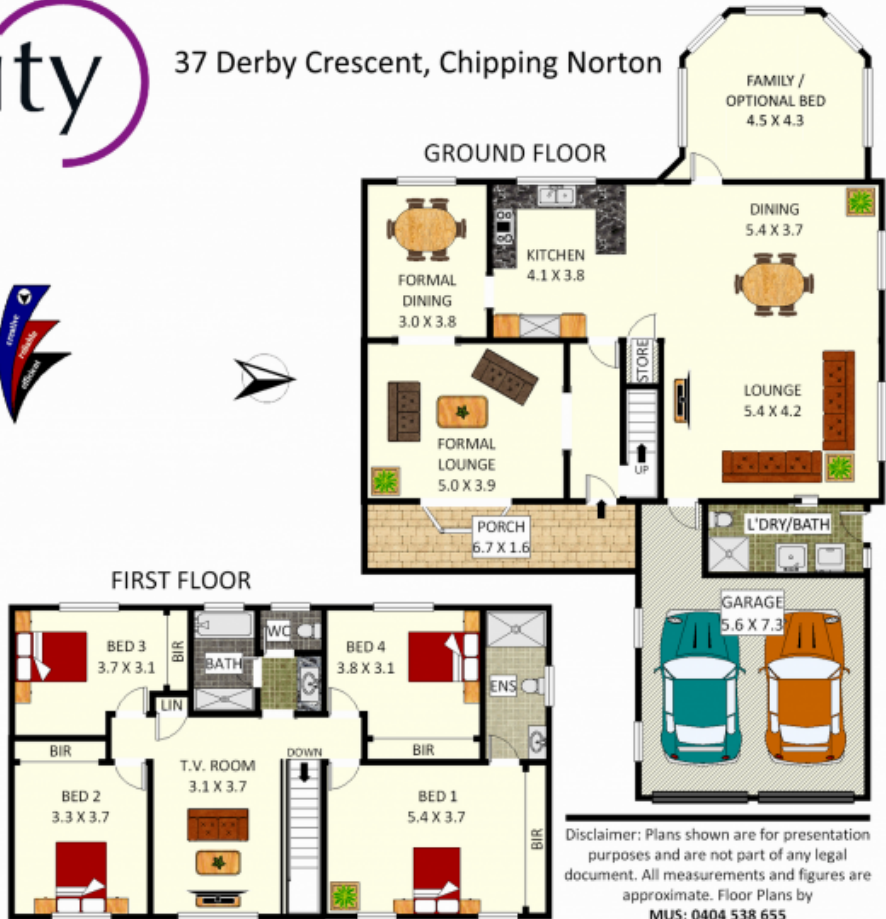

Plans shown are only indicative of layout. Dimensions are approximate.