



Chipping Norton, NSW

25 Aylesbury Crescent

4
BED

2
BATH

2
CAR

RealEquity
estate agents

Stretched across one generous level, this exceptional residence offers loads of homely comforts along with an abundance of entertaining areas perfect for hosting family and friends all whilst maintaining a peaceful and serene lifestyle.

Features:

- Wide foyer leading to living spaces
- Spacious lounge room & separate dining
- Gourmet timber kitchen, granite benchtops
- Meals area leading to large private backyard
- 4 great size bedrooms with built in robes

SOLD - \$1,060,000

Contact:

Anthony Prestia
02 9755 4222
0414 775 577
Joshua Prestia
02 9755 4222
0404 252 695

Type:

House

Sold Date:

29/09/2017

Land:

670m2

<https://www.realequity.com.au>

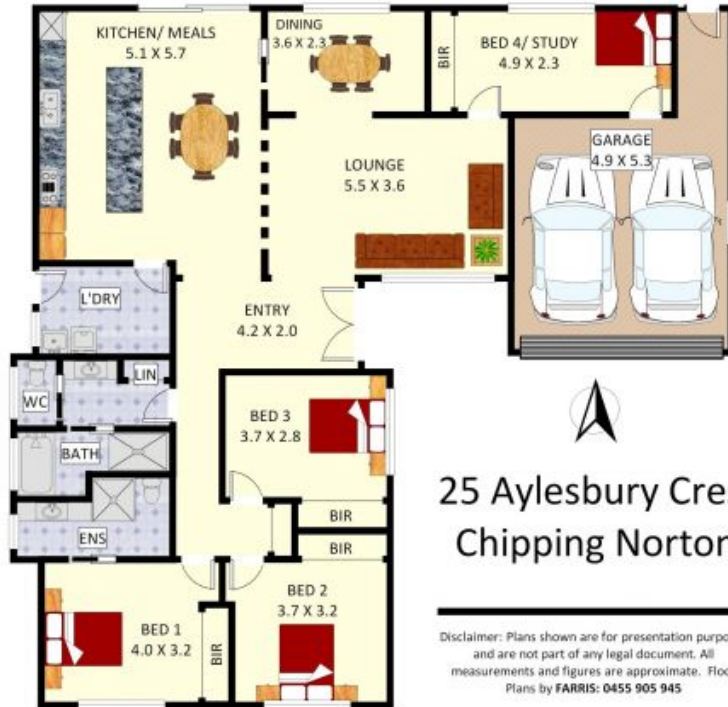

**25 Aylesbury Cres,
Chipping Norton**

Disclaimer: Plans shown are for presentation purposes and are not part of any legal document. All measurements and figures are approximate. Floor Plans by FARRIS: 0455 905 945



Plans shown are only indicative of layout. Dimensions are approximate.

Chipping Norton, NSW
25 Aylesbury Crescent