



## Chipping Norton, NSW

11 Derby Crescent

**4** BED  
**2** BATH  
**2** CAR

**RealEquity**  
estate agents

Lush green grounds, lovely entertaining spaces and high security gates and fences set the scene for the growing family or perhaps the purchaser looking to downsize to a single level residence that can comfortably be your own private retreat.

### Features

- High fences with hedges & security gates
- Long driveway & landscaped grounds
- Wide foyer with double door entrance
- Huge lounge and dining overlooking pool
- Excellent kitchen with 40mm stone bench

**SOLD - \$1,035,000**

**Contact:** Joshua Prestia  
02 9755 4222  
0404 252 695  
Anthony Prestia  
02 9755 4222  
0414 775 577

**Type:** House  
**Sold Date:** 26/10/2017  
**Land:** 776m2

<https://www.realequity.com.au>

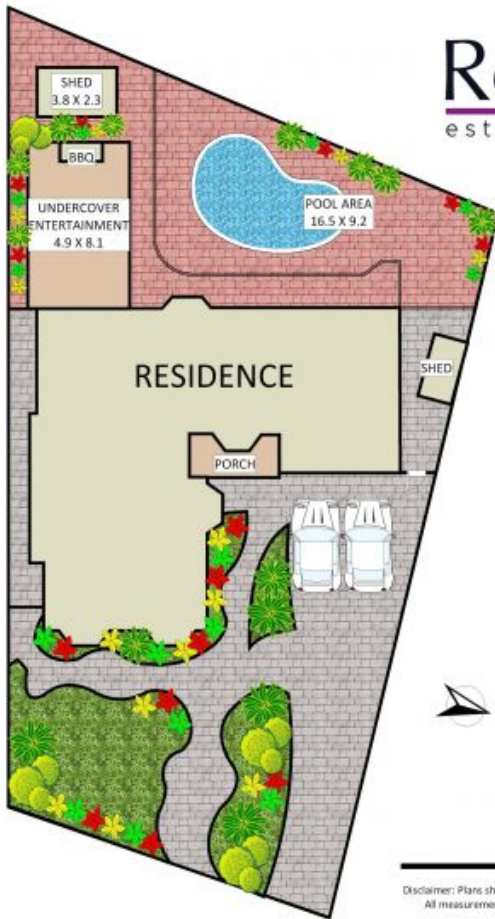

Disclaimer: Plans shown are for presentation purposes and are not part of any legal document.  
All measurements and figures are approximate. Floor Plans by FARRIS: 0455 905 945

Plans shown are only indicative of layout. Dimensions are approximate.

**Chipping Norton, NSW**  
11 Derby Crescent