



## Chipping Norton, NSW

4 Derby Crescent

**4**  
BED

**2**  
BATH

**3**  
CAR

**RealEquity**  
estate agents

The lovely spacious interior, immaculate presentation and superb entertaining spaces has created an extremely comfortable lifestyle that is perfectly suited to the growing family or perhaps the homebuyer looking to enjoy single level living at its finest.

### Features

- Inviting facade with landscaped gardens
- Wide foyer with double door entrance
- Huge lounge room with combustion fireplace
- Large Stylish kitchen with stone benchtops
- Massive dining room leading to QLD room

**SOLD - \$990,000**

### Contact:

Joshua Prestia  
02 9755 4222  
0404 252 695  
Anthony Prestia  
02 9755 4222  
0414 775 577

### Type:

House

### Sold Date:

15/11/2017

### Land:

748m2

<https://www.realequity.com.au>



4 Derby Crescent,  
Chipping Norton

Disclaimer: Plans shown are for presentation purposes and are not part of any legal document.  
All measurements and figures are approximate. Floor Plans by FARRIS: 0455 905 945

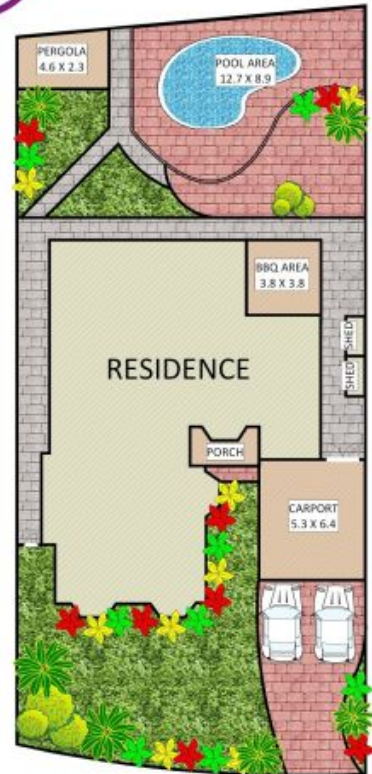

Plans shown are only indicative of layout. Dimensions are approximate.

**Chipping Norton, NSW**  
4 Derby Crescent