



Picnic Point, NSW

22 Eucalyptus Court

5
BED

2
BATH

2
CAR

RealEquity
estate agents

Enjoying an inviting East aspect and an extremely appealing streetscape, this spacious residence stretches over two generous levels offering an attractive modern floorplan, superb entertaining spaces and an ideal setup to cater to the entire family.

Features:

- Lovely facade with landscaped gardens
- Wide entrance foyer leading to living areas
- Large lounge room and separate dining area
- Gourmet kitchen, stainless steel appliances
- Granite benchtops and timber finishes

SOLD - \$1,100,000

Contact: Joshua Prestia
02 9755 4222
0404 252 695

Type: House
Sold Date: 30/04/2018

Land: 441m2

<https://www.realequity.com.au>

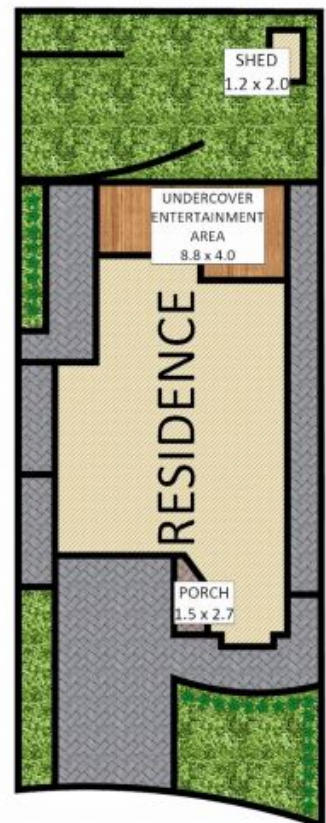

Disclaimer: Plans shown are for presentation purposes and are not part of any legal document. All measurements and figures are approximate. Floor Plans by MUS: 0404 538 655

Plans shown are only indicative of layout. Dimensions are approximate.

Picnic Point, NSW
22 Eucalyptus Court