



**Picnic Point, NSW**  
22 Eucalyptus Court

<b>5</b> BED	<b>2</b> BATH	<b>2</b> CAR	<b>RealEquity</b> estate agents
-----------------	------------------	-----------------	------------------------------------

Enjoying an inviting East aspect and an extremely appealing streetscape, this spacious residence stretches over two generous levels offering an attractive modern floorplan, superb entertaining spaces and an ideal setup to cater to the entire family.

**Features:**

- Lovely facade with landscaped gardens
- Wide entrance foyer leading to living areas
- Large lounge room and separate dining area
- Gourmet kitchen, stainless steel appliances
- Granite benchtops and timber finishes

**SOLD - \$1,100,000**

**Contact:** Joshua Prestia  
02 9755 4222  
0404 252 695

**Type:** House  
**Sold Date:** 30/04/2018  
**Land:** 441m2

<https://www.realequity.com.au>

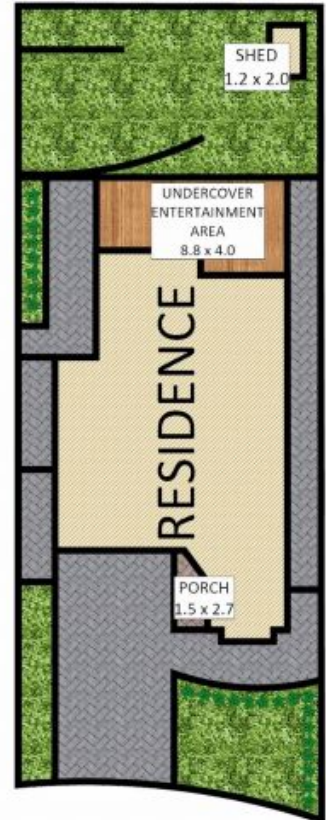
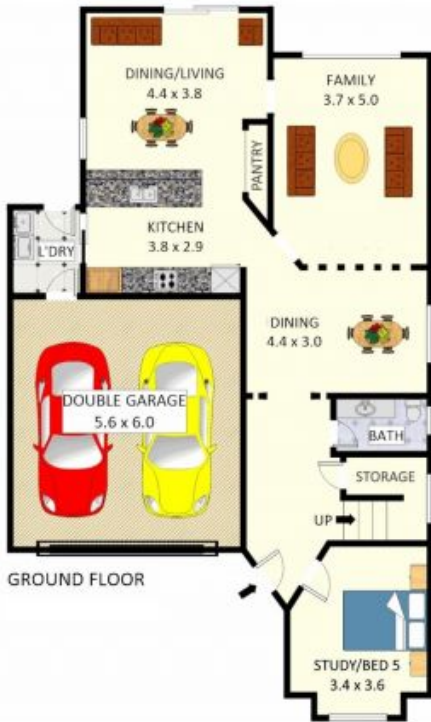

Disclaimer: Plans shown are for presentation purposes and are not part of any legal document. All measurements and figures are approximate. Floor Plans by MUS: 0404 538 655

Plans shown are only indicative of layout. Dimensions are approximate.

**Picnic Point, NSW**  
22 Eucalyptus Court