



Moorebank, NSW
9 Topin Place

4 BED	2 BATH	1 CAR	RealEquity estate agents
-----------------	------------------	-----------------	------------------------------------

Nestled in a quiet cul-de-sac with a superb high position, this excellent residence offers a fantastic opportunity to enter into the housing market in the growing suburb of Moorebank with loads of scope to add your own value for the future.

Features:

- Large foyer leading to living areas
- Spacious lounge room overlooking the yard
- Separate dining & family with fireplace
- Timber kitchen, plenty of cupboard space
- 4 great size bedrooms with built in robes

SOLD - \$833,000

Contact: Joshua Prestia
02 9755 4222
0404 252 695
Anthony Prestia
02 9755 4222
0414 775 577

Type: House
Sold Date: 21/06/2018
Land: 668m2
<https://www.realequity.com.au>

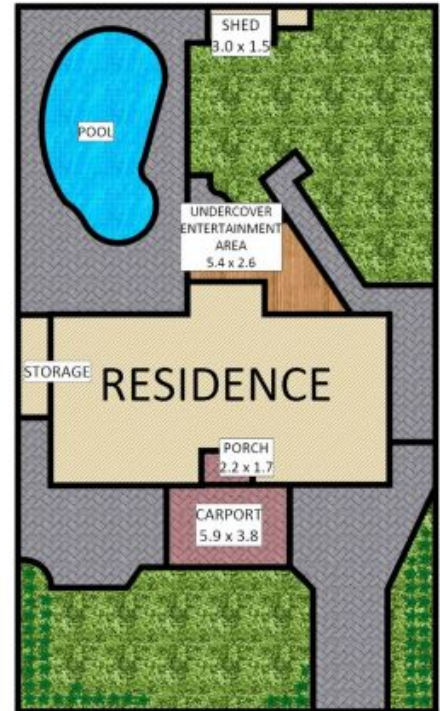

Disclaimer: Plans shown are for presentation purposes and are not part of any legal document. All measurements and figures are approximate. Floor Plans by MUS: 0404 538 655

Plans shown are only indicative of layout. Dimensions are approximate.

Moorebank, NSW
9 Topin Place