



Chipping Norton, NSW
18 Aylesbury Crescent

4 BED	2 BATH	2 CAR	RealEquity estate agents
-----------------	------------------	-----------------	------------------------------------

Presented with absolute perfection and modernised to appeal to the most astute of buyers, this impeccable residence combines the ideal floorplan with separate living areas, inviting entertaining spaces and a huge backyard perfect for the kids or perhaps a granny flat to earn an extra income.

Features

- Beautifully manicured gardens & grounds
- An extremely appealing streetscape
- Open plan lounge & dining + study nook
- Large Galley style kitchen with timber finishes

SOLD - \$997,500

Contact: Joshua Prestia
02 9755 4222
0404 252 695
Anthony Prestia
02 9755 4222
0414 775 577

Type: House
Sold Date: 20/07/2018
Land: 725m2
<https://www.realequity.com.au>

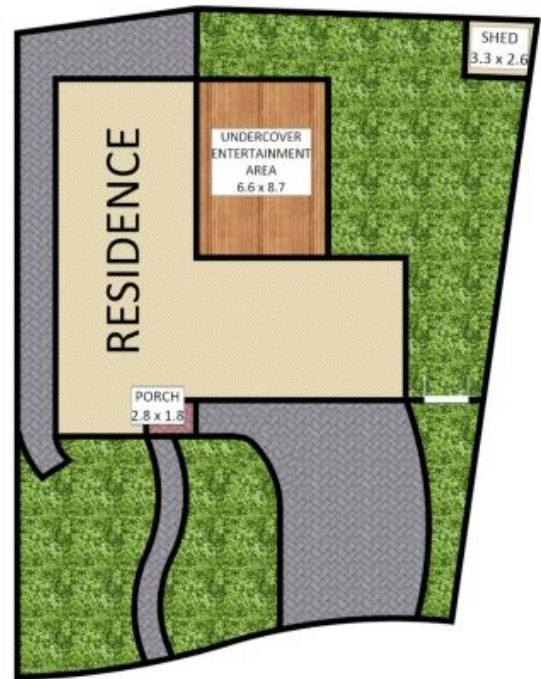

Disclaimer: Plans shown are for presentation purposes and are not part of any legal document. All measurements and figures are approximate. Floor Plans by MUS: 0404 538 655

Plans shown are only indicative of layout. Dimensions are approximate.