



Wattle Grove, NSW
8 Gracemere Court

4 BED	2 BATH	2 CAR	RealEquity estate agents
-----------------	------------------	-----------------	------------------------------------

Pleasantly nestled in a quiet and convenient location; this excellent home offers a rare existence for the buyer looking to make the move to Wattle Grove. With an open plan living and stylish interiors and designed to entertain with an attractive outdoor setting, one could say this is a perfect start in Wattle Grove.

- Features:
- Entrance to open plan lounge room
 - New kitchen, stainless steel appliances, stylish featured ceiling
 - 4 great size bedrooms with built in wardrobes, main with ensuite

By Negotiation
Contact: Joshua Prestia
 02 9755 4222
 0404 252 695
 Joshua Prestia
 02 9755 4222
 0404 252 695
Type: House
Sold Date: 15/07/2019
Land: 467m2
<https://www.realequity.com.au>

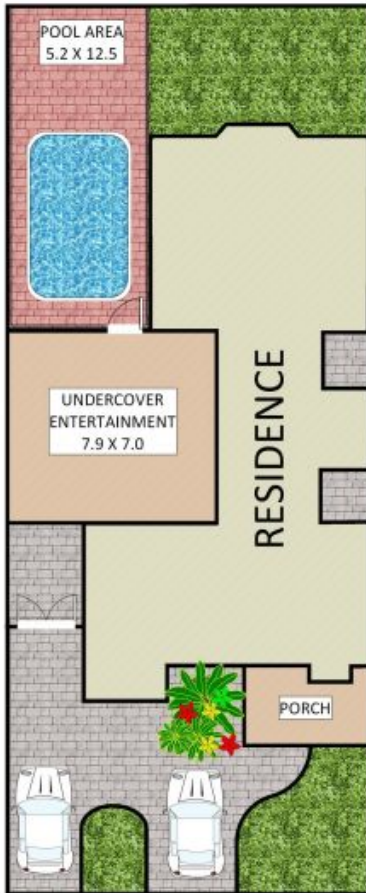

Real Equity
estate agents

8 Gracemere Court,
Wattle Grove



Disclaimer: Plans shown are for presentation purposes and are not part of any legal document.

All measurements and figures are approximate.
Floor Plans by FARRIS: 0455 905 945



Plans shown are only indicative of layout. Dimensions are approximate.

Wattle Grove, NSW
8 Gracemere Court