



**Wattle Grove, NSW**  
7 Evandale Court

**3** BED **2** BATH **2** CAR



Presenting a bright three bedroom residence on a generous size of land in Wattle Grove that will cater for the whole family; with a good size grassland for the kids to run around whilst still entertaining the guest in the undercover alfresco area, this home provides the perfect setting for the growing family.

- Features:
- Inviting foyer leading to open lounge/dining
  - Stylish kitchen complete with gas cooking
  - 3 generous bedrooms, all with built ins
  - Master with elegant ensuite & walk in

**Contact Agent**

**Contact:** Joshua Prestia  
02 9755 4222  
0404 252 695  
Joshua Prestia  
02 9755 4222  
0404 252 695

**Type:** House  
**Sold Date:** 16/07/2019  
**Land:** 603m2  
<https://www.realequity.com.au>

7 Evandale Court,  
Wattle Grove

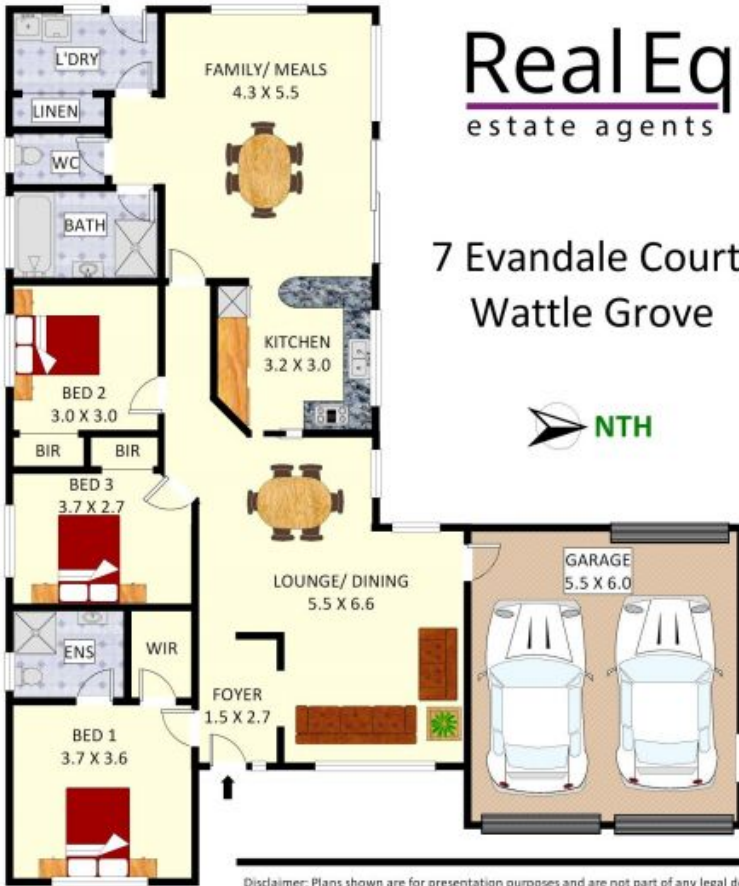

Disclaimer: Plans shown are for presentation purposes and are not part of any legal document. All measurements and figures are approximate. Floor Plans by FARRIS: 0455 905 945

Plans shown are only indicative of layout. Dimensions are approximate.

**Wattle Grove, NSW**  
7 Evandale Court