



Wattle Grove, NSW
16 Ellesmere Court

3 BED **1** BATH **3** CAR



A design that maximises the use of living that is set on a 455 sqm parcel of land is this 3 bedroom residence situated in the Lakeside location of Wattle Grove. A fresh look that boasts neutral colours and style while offering an open plan layout and an entertainers yard, one could say it ticks all the boxes when searching for a home.

- Lovely entrance hallway leading to family/lounge
- Open style kitchen with gas cooking and breakfast bar
- Spacious dining room overlooking alfresco
- Large undercover entertainers alfresco with BBQ area
- 3 generous bedrooms with built in robes

By Negotiation

Contact: Joshua Prestia
02 9755 4222
0404 252 695
Joshua Prestia
02 9755 4222
0404 252 695

Type: House
Sold Date: 16/09/2019
Land: 455m2
<https://www.realequity.com.au>



NTH

16 Ellesmere
Court,
Wattle Grove

Disclaimer: Plans shown are for presentation purposes and are not part of any legal document.

All measurements and figures are approximate.

Floor Plans by FARRIS: 0455 905 945

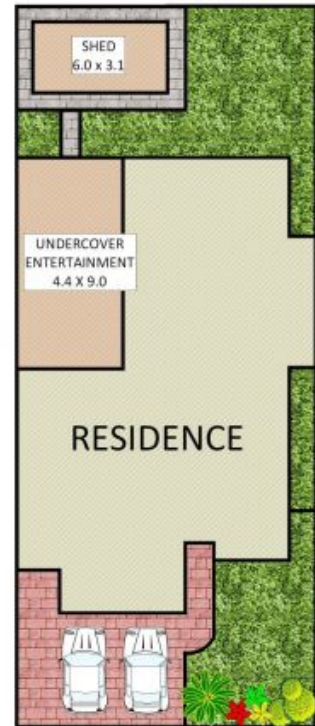

Plans shown are only indicative of layout. Dimensions are approximate.

Wattle Grove, NSW
16 Ellesmere Court