



RealEquity



uity



RealEquity

Chipping Norton, NSW
64 Rugby Crescent

3 BED **1** BATH **2** CAR

RealEquity
estate agents

A sprawling wide frontage, instantly appealing gardens and an abundance of accommodation for car parking with a circular driveway makes this residence an ideal place to call home. Walking through to the perfectly maintained interior where you can move in and enjoy or perhaps add your own tastes to your desire.

- Features:
- Beautifully manicured and landscaped gardens
 - Inviting foyer leading to open plan living & dining
 - Lovely timber kitchen with spacious meals area
 - 3 great size bedroom with built in wardrobes

\$550.00 per week
Contact: Investment Management Team
 0297554222
Type: House
Date Available: 14/10/2019
Land: 678m2
<https://www.realequity.com.au>

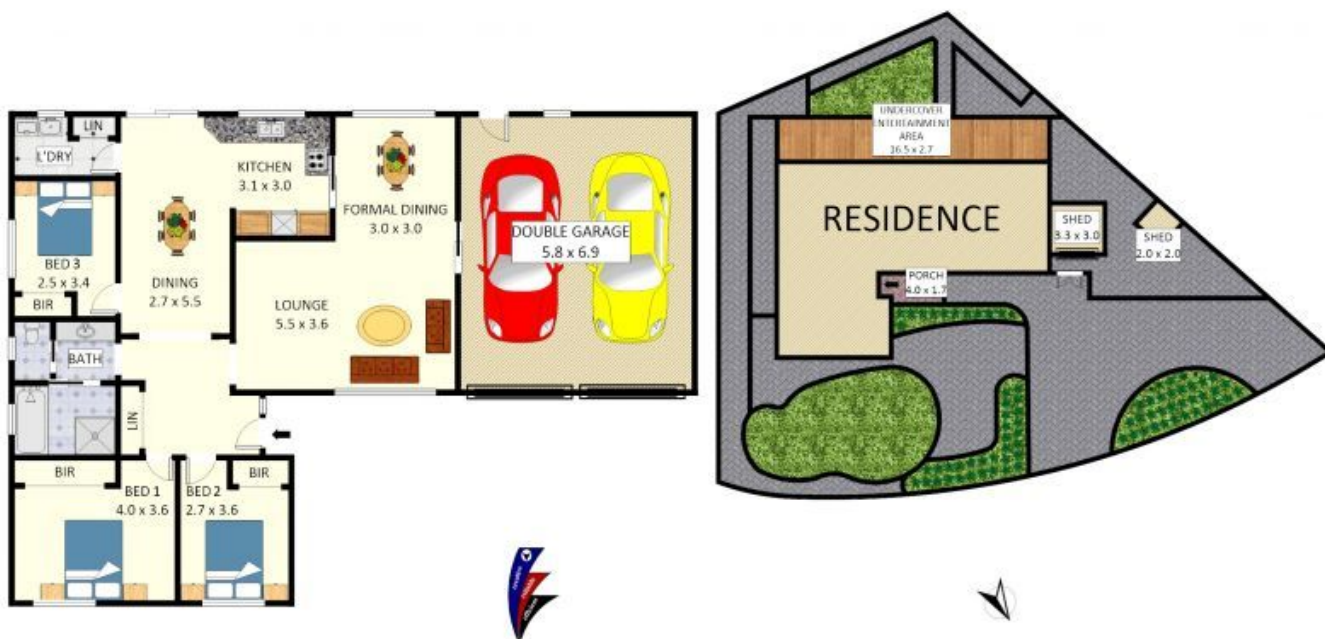

Disclaimer: Plans shown are for presentation purposes and are not part of any legal document. All measurements and figures are approximate. Floor Plans by MUS: 0404 538 655

Plans shown are only indicative of layout. Dimensions are approximate.

Chipping Norton, NSW
64 Rugby Crescent