



RealEquity



RealEquity



RealEquity

Chipping Norton, NSW

32 Whelan Avenue

4
BED

3
BATH

3
CAR

RealEquity
estate agents

\$1,130,000

Contact:

Joshua Prestia
02 9755 4222
0404 252 695
Anthony Prestia
02 9755 4222
0414 775 577

Type:

House

Sold Date:

30/04/2020

Land:

670m2

<https://www.realequity.com.au>

An inspiring renovation complete with the highest quality inclusions that provides the perfect combination of marble finishes, timber accents and warm neutral colours creating the epitome of single level living.

Features:

- Lush green landscaped gardens leading to inviting entrance
- Beautiful open plan lounge and dining spaces
- Gourmet kitchen with marble finishes, huge island bench and walk-in pantry
- Fixed glass panels from kitchen overlooking pool
- Separate rumpus room or children's retreat area



**32 Whelan Avenue,
Chipping Norton**



Disclaimer: Plans shown are for presentation purposes and are not part of any legal document. All measurements and figures are approximate.

Floor Plans by FARRIS: 0455 905 945

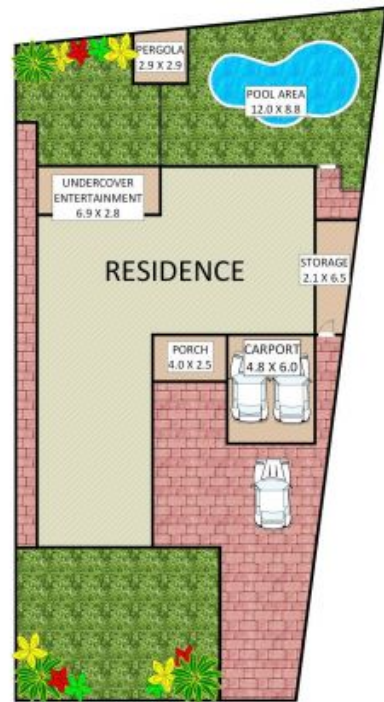

Plans shown are only indicative of layout. Dimensions are approximate.