



## Wattle Grove, NSW

54 Beltana Court

**4** BED **3** BATH **2** CAR

**RealEquity**  
estate agents

With excellent sized living areas, loads of outdoor entertaining space, peaceful surroundings and loads of scope to add your own taste this fantastic family home stretches over one inviting level and boasts a sensational sense of comfort for the whole family to enjoy.

### Features:

- Entrance leading to large formal lounge room
- Stylish kitchen with an open plan design
- Family/meals area with easy access to the backyard
- Formal dining area with lovely Bay Windows

### By Negotiation

**Contact:** Joshua Prestia  
02 9755 4222  
0404 252 695

**Type:** House  
**Sold Date:** 09/05/2020

**Land:** 654.6m2  
<https://www.realequity.com.au>

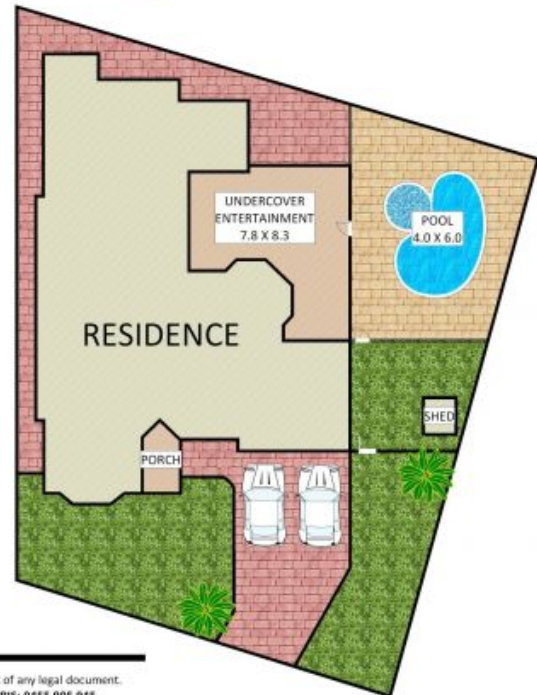

Disclaimer: Plans shown are for presentation purposes and are not part of any legal document.  
All measurements and figures are approximate. Floor Plans by FARRIS: 0455 905 945

Plans shown are only indicative of layout. Dimensions are approximate.

**Wattle Grove, NSW**  
54 Beltana Court