



## Wattle Grove, NSW

19 Bundarra Court

4  
BED

2  
BATH

2  
CAR

RealEquity  
estate agents

This lovely single level residence offers a flowing floorplan with inviting interiors that are sure to leave a lasting impression. This home has been maintained beautifully and presents itself as new with the choice of colours that provides a sense of warmth and comfort, combined with an abundance of natural light that showcase all the wonderful features this home has to offer.

Features:

- Lovely facade with loads of greenery
- Entrance leading to main living areas
- Gorgeous kitchen with gas-top cooking

**SOLD - \$950,000**

**Contact:** Joshua Prestia  
02 9755 4222  
0404 252 695

**Type:** House  
**Sold Date:** 10/09/2020

**Land:** 550.8m2

<https://www.realequity.com.au>

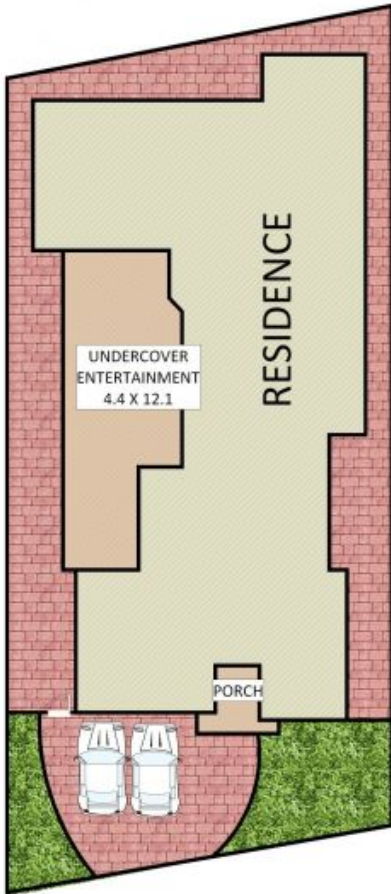

**Real Equity**  
estate agents

19 Bundarra Court,  
Wattle Grove



Disclaimer: Plans shown are for presentation purposes  
and are not part of any legal document.

All measurements and figures are approximate.  
Floor Plans by FARRIS: 0455 905 945



Plans shown are only indicative of layout. Dimensions are approximate.

**Wattle Grove, NSW**  
19 Bundarra Court