



Chipping Norton, NSW

245 Epsom Road

5
BED

2
BATH

2
CAR

RealEquity
estate agents

(A.K.A - 1A Sammut Crescent, Chipping Norton)

Instantly appealing with manicured and low-maintenance gardens, a desirable residence awaits, offering a perfect lifestyle for a large family, to take advantage of this spacious double-storey detached dwelling.

Features:

- Lovely foyer leading to formal living area
- Huge open plan family room
- Gourmet kitchen with breakfast bar and meals
- 4 great size bedrooms upstairs with built-in-robos

SOLD - \$835,000!

Contact:

Anthony Prestia
02 9755 4222
0414 775 577
Joshua Prestia
02 9755 4222
0404 252 695

Type:

House

Sold Date:

21/11/2020

<https://www.realequity.com.au>

Real Equity 245 Epsom Road, estate agents Chipping Norton



A.K.A 1A Sammut Crescent, Chipping Norton

Disclaimer: Plans shown are for presentation purposes and are not part of any legal document.

All measurements and figures are approximate.
Floor Plans by FARRIS: 0455 905 945

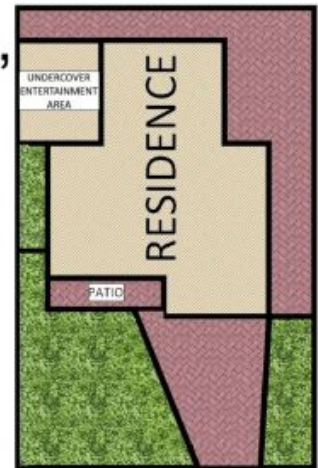

Plans shown are only indicative of layout. Dimensions are approximate.

Chipping Norton, NSW
245 Epsom Road