



RealEquity



RealEquity



RealEquity

**Wattle Grove, NSW**  
23 Banyule Court

**5** BED  
**3** BATH  
**2** CAR



Instantly captivating with beautifully manicured grounds and gardens, this exquisite residence boasts luxurious appointments with a great sense of comfort. Providing an open floorplan and sun-drenched living areas, this home offers a serene lifestyle, perfect for the entire family to enjoy.

**Features:**

- Gorgeous landscaped lawns, leading to entrance
- Beautifully presented family area with bar
- Open style dining area, overlooking backyard
- Gorgeous kitchen with stainless steel appliances
- Kitchen with servery window and walk-in pantry

**SOLD!**

**Contact:** Joshua Prestia  
02 9755 4222  
0404 252 695

**Type:** House  
**Sold Date:** 28/11/2020

**Land:** 540m2  
<https://www.realequity.com.au>

23 Banyule Court, Wattle Grove



Ground Floor

Disclaimer: Plans shown are for presentation purposes and are not part of any legal document.

All measurements and figures are approximate. Floor Plans by FARRIS: 0455 905 945

First Floor

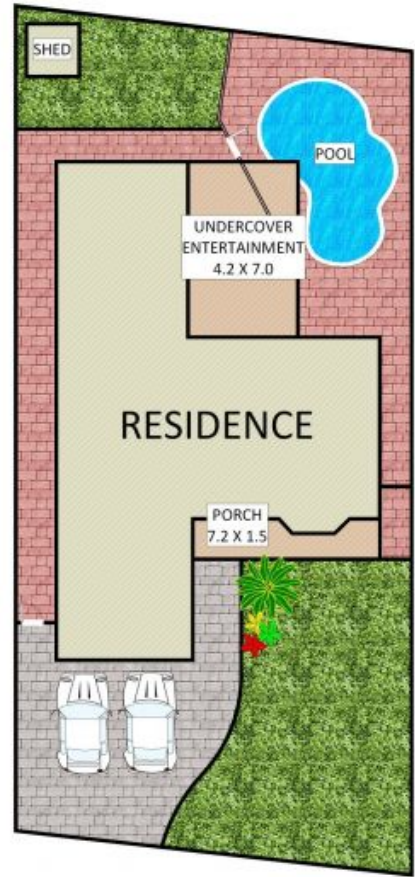

Plans shown are only indicative of layout. Dimensions are approximate.