



Wattle Grove, NSW
24 Burdekin Court

3 BED	1 BATH	2 CAR	RealEquity estate agents
-----------------	------------------	-----------------	------------------------------------

Presented as new with contemporary inclusions, this beautiful home stretches over one stylish level and includes open plan living areas that are infused with natural sunlight. Offering a flowing floorplan that creates a seamless transition from indoor to outdoor living, this home is perfect for the family looking to start their journey in the growing suburb of Wattle Grove.

- Features:
- Lovely facade with manicured lawns and gardens
 - Long hallway extending down to main living areas
 - Sun-infused, combined living/dining area

Contact Bill 0424 190 290 or Darrell 0411 247 186

Contact: Joshua Prestia
02 9755 4222
0404 252 695

Type: House
Sold Date: 15/01/2021

Land: 439m2
<https://www.realequity.com.au>



FLOOR PLAN

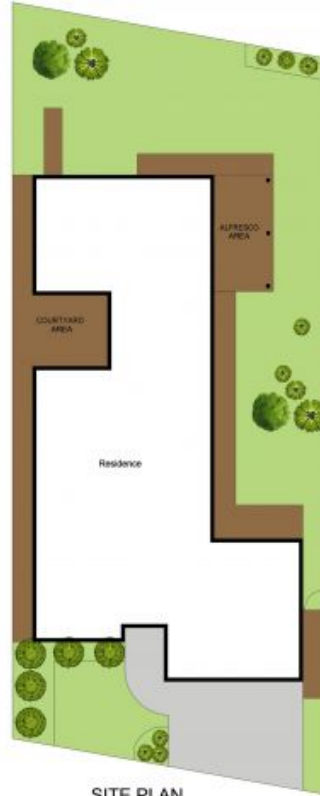

SITE PLAN

24 Burdekin Court Wattle Grove

Whilst every attempt has been made to ensure the accuracy of the floor plan contained here, measurements of doors, windows, rooms and any other items are approximate and no responsibility is taken for any error, omission, or misstatement. This plan is for illustrative purposes only and should be used as such by any prospective purchaser.

Real Equity
estate agents

Plans shown are only indicative of layout. Dimensions are approximate.

Wattle Grove, NSW
24 Burdekin Court