



WATTLE GROVE, NSW

19 Culgoa Court

4
BED

2
BATH

2
CAR

RealEquity
estate agents

Situated on a great corner block and in the growing suburb of Wattle Grove, this beautiful dual-level residence presents itself as new with its stylish and quality inclusions. An instantly captivating facade that lures you into a phenomenal interior offering a seamless transition from indoor to outdoor living, this home is absolutely perfect for the family who love to entertain as it contains large open living areas and a sparkling swimming pool creating the epitome of luxurious living.

A Few Inviting Features:

- Appealing facade with manicured lawns

SOLD!

Contact: Joshua Prestia
02 9755 4222
0404 252 695

Type: House

Sold Date: 13/08/2021

Land: 352m²

<https://www.realequity.com.au>

19 Culgoa Ct,
Wattle Grove



First Floor

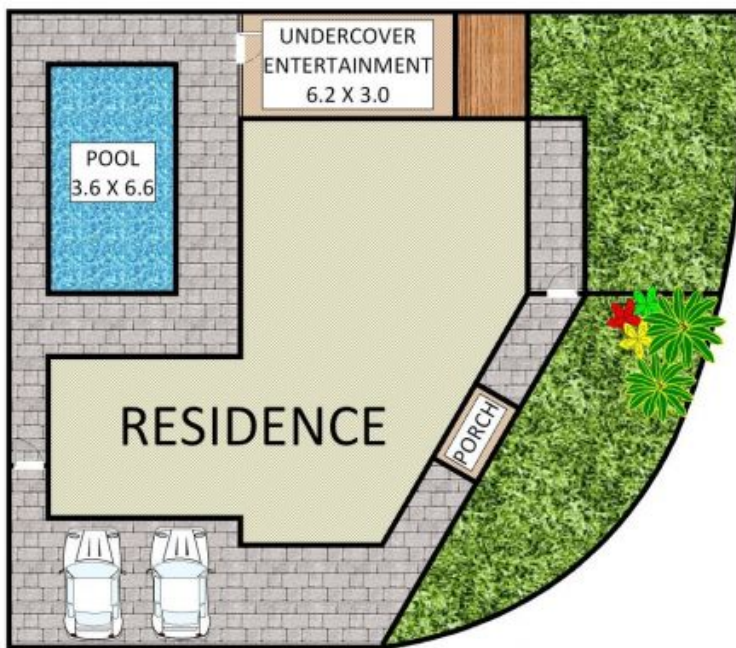

Ground Floor

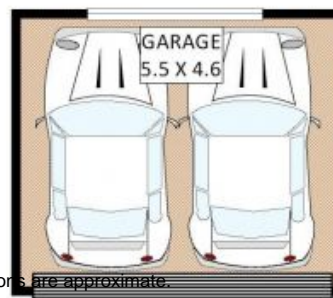

Disclaimer: Plans shown are for presentation purposes and are not part of any legal document. All measurements and figures are approximate.

Plans shown are only indicative of layout. Dimensions are approximate.

WATTLE GROVE, NSW
19 Culgoa Court