



CHIPPING NORTON, NSW

1/243 Epsom Road

2
BED

1
BATH

2
CAR

RealEquity
estate agents

One of the largest and most appealing two bedroom townhouses in the suburb yet still capturing the true essence of a modern low maintenance lifestyle with stylish and contemporary finishes throughout; welcome to 1/243 Epsom Road Chipping Norton.

A Few Inviting Features:

- Appealing facade, situated in a lovely complex
- Open plan living area upon entrance of home
- Kitchen includes stainless steel appliances
- Gas-top cooking and ample cupboard space
- Sun-infused dining overlooking wrap-around yard

SOLD!

Contact:

Joshua Prestia
02 9755 4222
0404 252 695
Antonio Furfaro
02 9755 4222
0455 077 861

Type:

House

Sold Date:

05/07/2021

<https://www.realequity.com.au>



First Floor

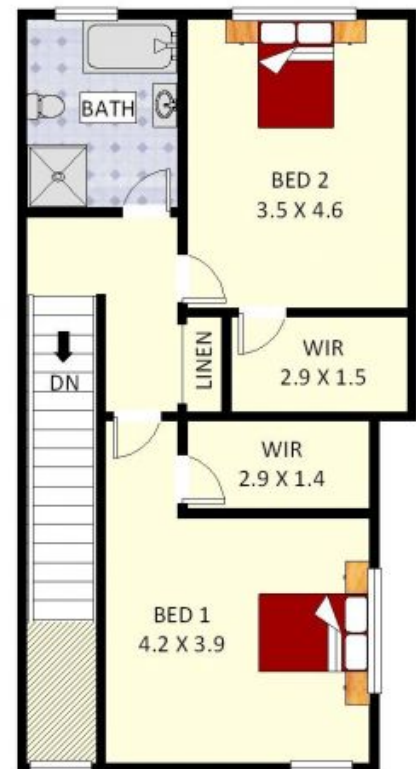

Basement

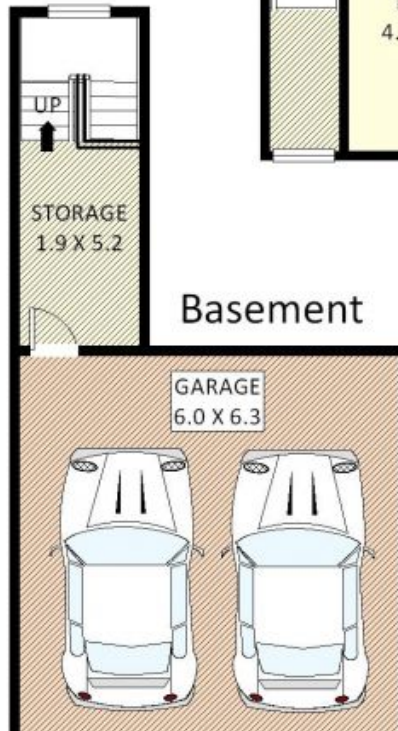

Disclaimer: Plans shown are for presentation purposes and are not part of any legal document. All measurements and figures are

Plans shown are only indicative of layout. Dimensions are approximate.

CHIPPING NORTON, NSW
1/243 Epsom Road