



HOLSWORTHY, NSW
60 Mubo Crescent

3 BED
1 BATH
1 CAR



An exceptionally well presented three bedroom home that has been loved by the same family for over 20 years. This lovely home offers a very appealing lifestyle within close proximity to Holsworthy Train Station and Wattle Grove Shopping Village.

A Few Inviting Features:

- Attractive facade with well manicured gardens
- Spacious separate lounge upon entry
- Flow through to good sized dining area
- Additional living space adjoining open plan kitchen
- Excellent kitchen with plenty of cupboard and bench space

SOLD!

Contact: Joshua Prestia
02 9755 4222
0404 252 695
Ammar El Ayoubi
02 9755 4222
0455 245 802

Type: House
Sold Date: 17/08/2021
Land: 588m2
<https://www.realequity.com.au>

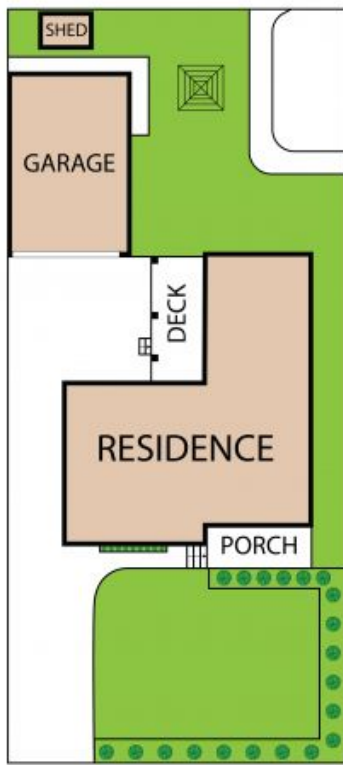

60 Mubo Crescent, Holsworthy 2173

TOTAL APPROX. FLOOR AREA 101 SQM

Whilst every attempt has been made to ensure the accuracy of the floor plan contained here, measurements of doors, windows, rooms and any other items are approximate and no responsibility is taken for any error, omission, or misstatement. This plan is for illustrative purposes only and should be used as such by any prospective purchaser.

Plans shown are only indicative of layout. Dimensions are approximate.

HOLSWORTHY, NSW
60 Mubo Crescent