



## WATTLE GROVE, NSW

9 Farnborough Court

**3** BED  
**2** BATH  
**1** CAR



Situated in a sought after position and located within walking distance to the local park, this superb single level design has a versatile floorplan. Spacious living areas indoors and an undercover entertaining area outside with a sparkling swimming pool providing a lovely sense of comfort for the entire family to enjoy.

**A Few Inviting Features:**

- A lovely facade located in a quiet street
- Large, open living area upon entrance
- Kitchen with ample cupboard space
- Gas cooking and stainless steel appliances

**SOLD!**

**Contact:** Joshua Prestia  
02 9755 4222  
0404 252 695

**Type:** House

**Sold Date:** 01/09/2021

**Land:** 450m2

<https://www.realequity.com.au>

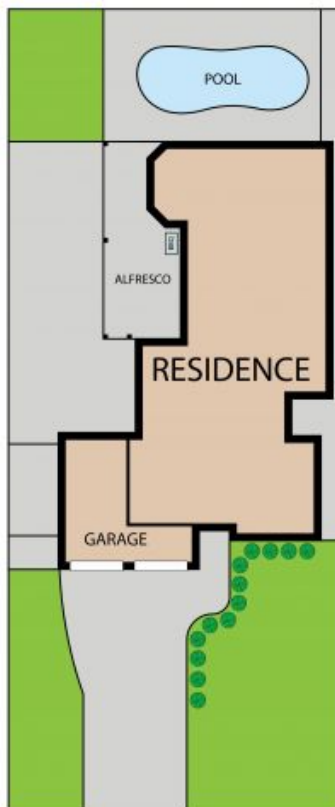

**RealEquity**  
estate agents

9 Farnborough Court, Wattle Grove 2173  
TOTAL APPROX. FLOOR AREA 141 SQ.M

Whilst every attempt has been made to ensure the accuracy of the floor plan contained here, measurements of doors, windows, rooms and any other items are approximate and no responsibility is taken for any error, omission, or misstatement. This plan is for illustrative purposes only and should be used as such by any prospective purchaser.

Plans shown are only indicative of layout. Dimensions are approximate.

**WATTLE GROVE, NSW**  
9 Farnborough Court