



CHIPPING NORTON, NSW

4 Galleon Close

4
BED

2
BATH

2
CAR

RealEquity
estate agents

This spacious & inviting originally owned home offers a very versatile floor plan with multiple living areas and a splendid child friendly backyard. Situated on a quiet cul-de-sac which provides plenty of options for the growing family seeking a move into the friendly neighborhood, surrounded by beautifully maintained quality homes and close to all local amenities including the Chipping Norton Market Plaza, schools, public transport and a short stroll to lakeside park.

A Few Inviting Features:

- Appealing facade with long driveway extending to porch on arrival
- Very large recreational room or lounge upon entry

SOLD!

Contact:

Joshua Prestia
02 9755 4222
0404 252 695
Anthony Prestia
02 9755 4222
0414 775 577

Type:

House

Sold Date:

05/11/2021

Land:

685.4m2

<https://www.realequity.com.au>

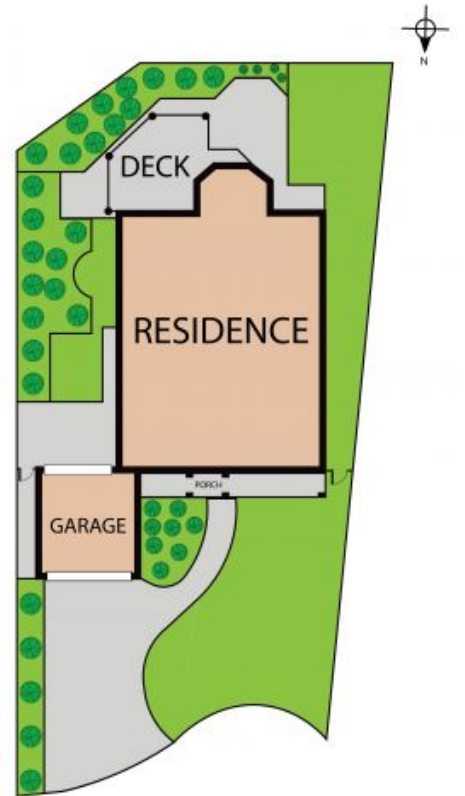

4 Galleon Close, Chipping Norton 2170

TOTAL APPROX. FLOOR AREA 317 SQ.M

Whilst every attempt has been made to ensure the accuracy of the floor plan contained here, measurements of doors, windows, rooms and any other items are approximate and no responsibility is taken for any error, omission, or misstatement. This plan is for illustrative purposes only and should be used as such by any prospective purchaser.

RealEquity
estate agents

Plans shown are only indicative of layout. Dimensions are approximate.

CHIPPING NORTON, NSW
4 Galleon Close