



## LIVERPOOL, NSW

12 Violet Avenue

**2**  
BED

**1**  
BATH

**1**  
CAR

**RealEquity**  
estate agents

This is the perfect opportunity to purchase a stand alone house for the price of a townhouse.

Situated just minutes from the Liverpool CBD, Liverpool Hospital, Westfield, schools & public transport, this home is ideally suited to first home buyers trying to get their foot into the property market or the keen investor looking to add to their portfolio.

A Few Inviting Features:

- Private front yard with well maintained lawns
- Open living & dining room upon entry
- Kitchen with gas top cooking

**SOLD!**

**Contact:** Antonio Furfaro  
02 9755 4222  
0455 077 861  
Anthony Prestia  
02 9755 4222  
0414 775 577

**Type:** House

**Sold Date:** 17/11/2021

**Land:** 289.8m2

<https://www.realequity.com.au>



FLOOR PLAN

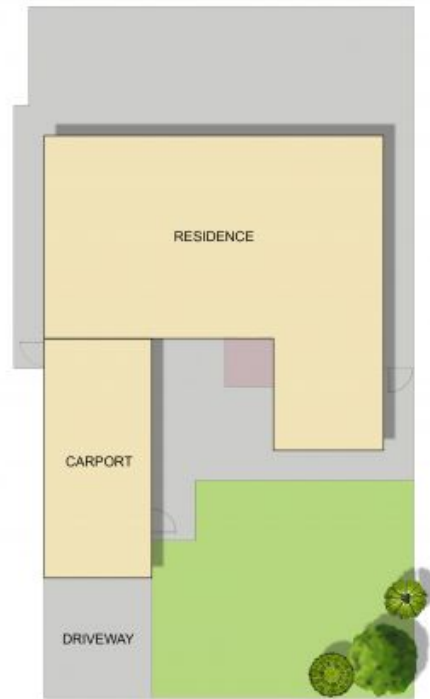

SITE PLAN

Whilst every attempt has been made to ensure the accuracy of the floor plan contained herein, measurements of doors, windows, rooms and any other items are approximate and no responsibility is taken for any error, omission, or misstatement. This plan is for illustrative purposes only and should be used as such by any prospective purchaser.

12 Violet Ave Liverpool

Real Equity  
estate agents

Plans shown are only indicative of layout. Dimensions are approximate.

**LIVERPOOL, NSW**  
12 Violet Avenue