



## CHIPPING NORTON, NSW

34 Banbury Crescent

**4**  
BED

**3**  
BATH

**2**  
CAR

**RealEquity**  
estate agents

This spacious two-storey home offers an expansive floor plan with 4 excellent upstairs bedrooms and multiple living & dining rooms on the ground floor. A generous backyard that consists of an inground swimming pool and various entertainment areas makes this home the perfect residence for growing families looking for a move into a family friendly neighbourhood.

Inviting Features Include:

- Attractive facade with well manicured gardens
- Spacious lounge upon entry, leading to formal dining room
- Well kept kitchen with electric cooktop, meals & bar area

**SOLD!**

**Contact:**

Anthony Prestia

02 9755 4222

0414 775 577

Joshua Prestia

02 9755 4222

0404 252 695

**Type:** House

**Sold Date:** 01/12/2021

**Land:** 747.4m2

**<https://www.realequity.com.au>**



FIRST FLOOR



GROUND FLOOR

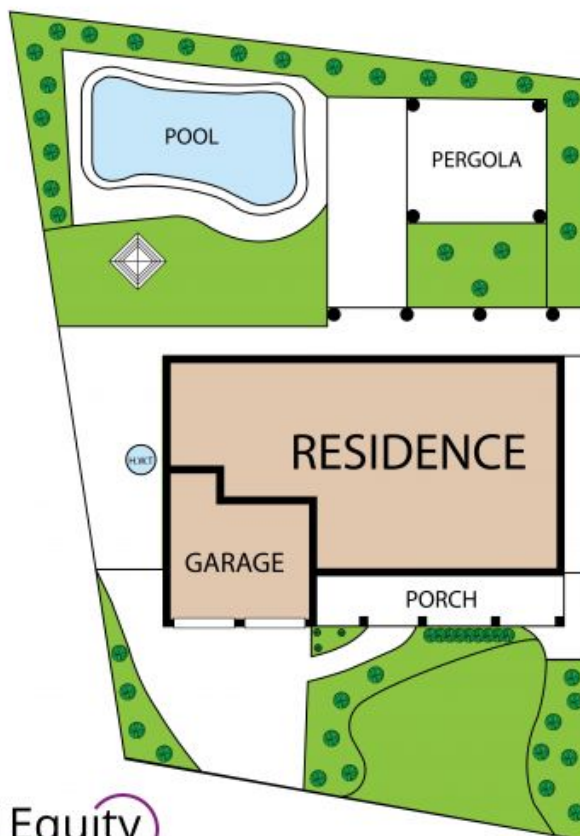

34 Banbury Crescent, Chipping Norton 2170

TOTAL APPROX. FLOOR AREA 219 SQM

Whilst every attempt has been made to ensure the accuracy of the floor plan contained here, measurements of doors, windows, rooms and any other items are approximate and no responsibility is taken for any error, omission, or misstatement. This plan is for illustrative purposes only and should be used as such by any prospective purchaser.

**RealEquity**  
estate agents

Plans shown are only indicative of layout. Dimensions are approximate.

**CHIPPING NORTON, NSW**  
34 Banbury Crescent