

CHIPPING NORTON, NSW

10 Ashfordby Street

3
BED

1
BATH

2
CAR

RealEquity
estate agents

This neat and tidy residence sitting on a 668.9sqm block with a 20.1m frontage in the heart of Chipping Norton offers loads of open plan living and is situated just minutes from local amenities including the Chipping Norton Market Plaza, schools, parklands and the M5 Motorway. This is an excellent opportunity to add and finish to the individual taste or take advantage of its development potential as a duplex site (s.t.c.a.) and capitalise in the future.

A Few Inviting Features:

- Attractive facade and with a wide frontage
- Huge open style living room with fireplace exposed to all open areas

SOLD!

Contact:

Anthony Prestia
02 9755 4222
0414 775 577
Joshua Prestia
02 9755 4222
0404 252 695

Type:

House

Sold Date:

09/12/2021

Land:

668.9m2

<https://www.realequity.com.au>

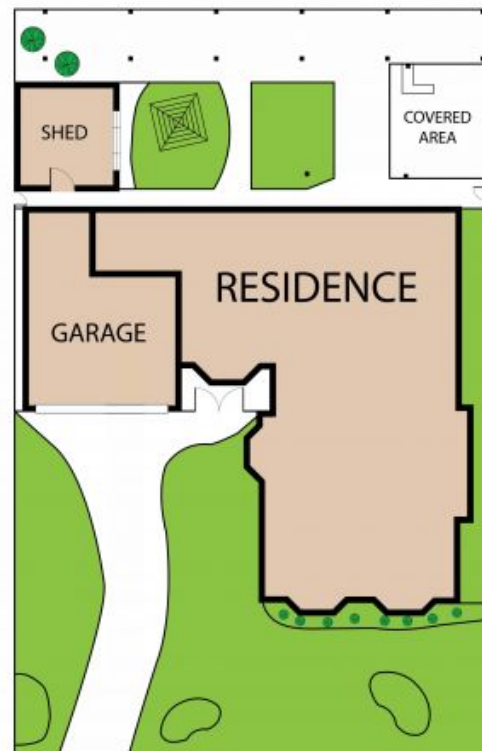
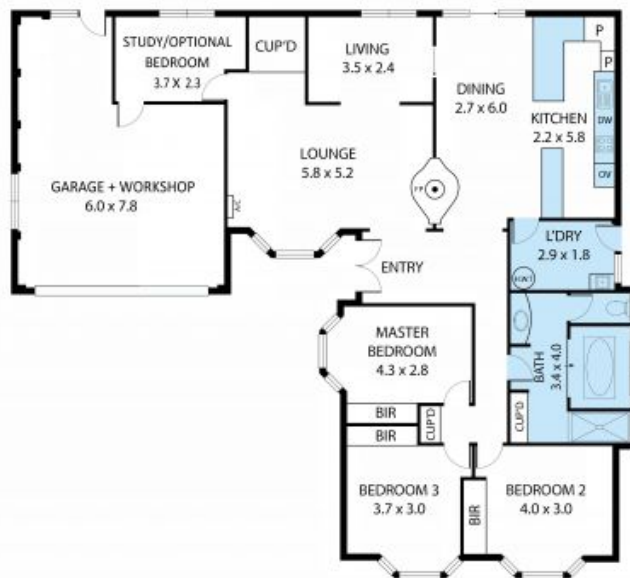

Real Equity
estate agents

10 Ashfordby Street, Chipping Norton 2170
TOTAL APPROX. FLOOR AREA 180 SQM

Whilst every attempt has been made to ensure the accuracy of the floor plan contained here, measurements of doors, windows, rooms and any other items are approximate and no responsibility is taken for any error, omission, or misstatement. This plan is for illustrative purposes only and should be used as such by any prospective purchaser.

Plans shown are only indicative of layout. Dimensions are approximate.

CHIPPING NORTON, NSW
10 Ashfordby Street