



## MOOREBANK, NSW

1 Nairn Place

**5**  
BED

**2**  
BATH

**2**  
CAR

**RealEquity**  
estate agents

Presented with an abundance of style, space and class is this fantastic five bedroom residence in the popular Brighton Lakes Estate. Offering a flexible floor plan with living spaces & bedrooms on both levels, as well as being situated in close proximity to all local amenities including schools, parklands, public transport and the M5 Motorway, this unique home is perfectly suited to growing families looking for a move into a peaceful estate.

#### A Few Inviting Features:

- Instantly captivating facade, well manicured gardens
- Spacious lounge with large built in gas fireplace

#### **SOLD!**

#### **Contact:**

Joshua Prestia  
02 9755 4222  
0404 252 695  
Joshua Prestia  
02 9755 4222  
0404 252 695

#### **Type:**

House

#### **Sold Date:**

07/02/2022

#### **Land:**

390m2

<https://www.realequity.com.au>

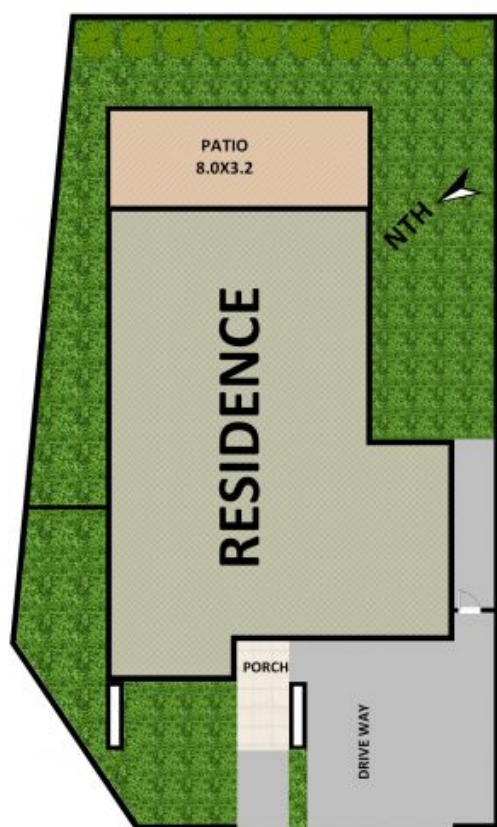

Disclaimer: Plans shown are for presentation purposes and are not part of any legal document. All measurements and figures are approximate.

JORDAN FLOOR PLANS: 0426400687



GROUND FLOOR

**Real Equity**  
estate agents



FIRST FLOOR

**1 Nairn Place,  
Moorebank**

Plans shown are only indicative of layout. Dimensions are approximate.

**MOOREBANK, NSW**  
1 Nairn Place