



CHIPPING NORTON, NSW

35 Derby Crescent

4
BED

2
BATH

2
CAR

RealEquity
estate agents

This lovely residence set in the heart area of Chipping Norton is fantastically presented and offers a sprawling floor plan with loads of living space and a massive alfresco and backyard perfect for entertaining guests. Ready to move in and enjoy, this spacious home is ideally suited to growing families and those looking to upsize.

A Few Inviting Features:

- Attractive facade with well-manicured gardens
- Lounge on entry extending to formal dining
- Spacious living room stretching out to alfresco
- Timber kitchen with ample cupboard space

SOLD!

Contact: Joshua Prestia
0297554222
0404252695
Matt Tasso
0297554222
0478881940

Type: House
Sold Date: 17/06/2022

Land: 572.4m2
<https://www.realequity.com.au>

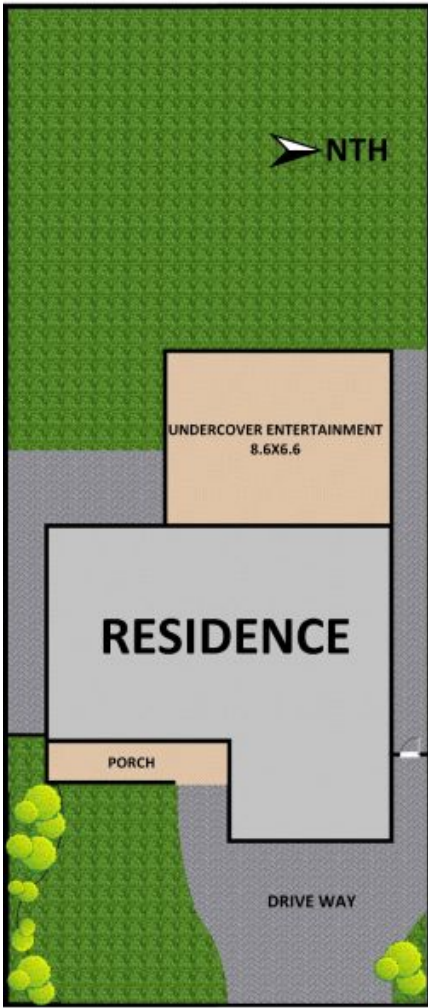

REAL EQUITY
estate agents

Disclaimer: Plans shown are for presentation purposes and are not part of any legal document. All measurements and figures are approximate.
JORDAN FLOOR PLANS: 0426400687

FIRST FLOOR



GROUND FLOOR

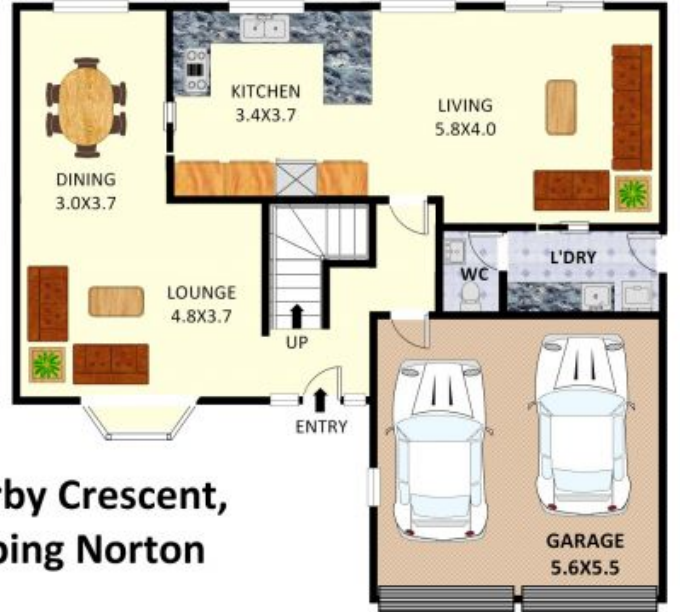

**35 Derby Crescent,
Chipping Norton**

Plans shown are only indicative of layout. Dimensions are approximate.

CHIPPING NORTON, NSW
35 Derby Crescent