



WATTLE GROVE, NSW

15 Tomago Court

4 BED
3 BATH
2 CAR

RealEquity
estate agents

Combining classical character features with modern inclusions is this expansive family residence located in the heart of the popular Wattle Grove. With an abundance of living space, delightful entertainment areas and a huge sparkling inground swimming pool, this home is sure to impress growing families seeking a ready to move in lifestyle full of comfort, style and relaxation.

A Few Inviting Features:

- Captivating facade & well manicured gardens
- Formal lounge extending to dining room
- Well kept timber kitchen with gas cooking

\$1,230,000

Contact:

Antonio Furfaro
02 9755 4222
0455 077 861
Joshua Prestia
02 9755 4222
0404 252 695

Type: House

Sold Date: 29/06/2022

Land: 697m2

<https://www.realequity.com.au>

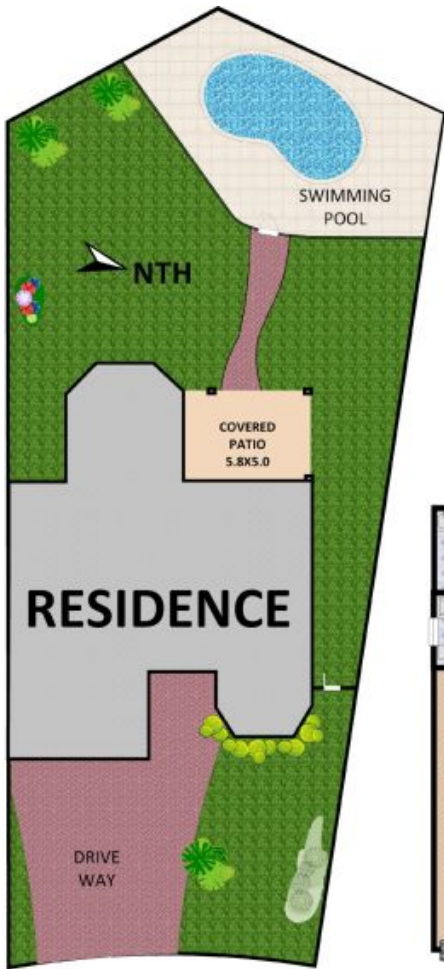

**REAL
EQUITY**
estate agents

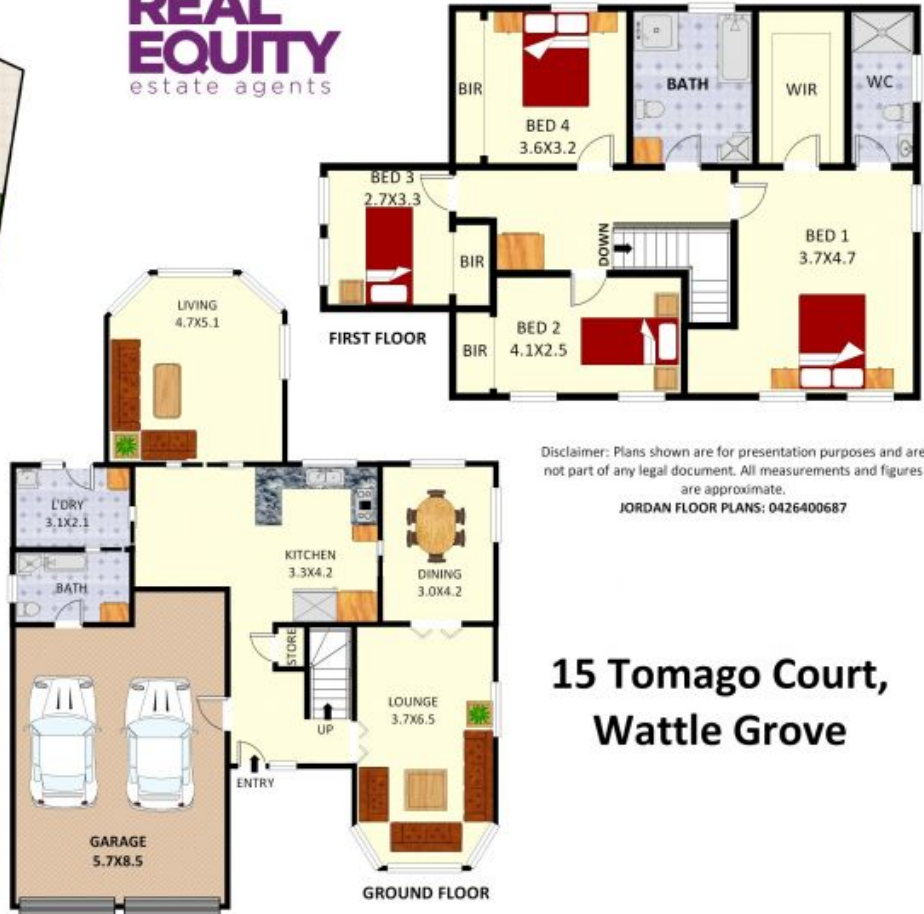

Disclaimer: Plans shown are for presentation purposes and are not part of any legal document. All measurements and figures are approximate.
JORDAN FLOOR PLANS: 0426400687

15 Tomago Court, Wattle Grove

Plans shown are only indicative of layout. Dimensions are approximate.

WATTLE GROVE, NSW
15 Tomago Court