



## CHIPPING NORTON, NSW

18 Whelan Avenue

**4** BED  
**3** BATH  
**2** CAR

**RealEquity**  
estate agents

This well presented residence is the perfect place for a family to call home, sitting on a spacious block size of 663.9sqm, this home provides space for a family to grow in a welcoming and warm atmosphere. With modern fixtures and features throughout, as well as great entertaining area, sparkling inground swimming pool, and space for the kids to play - this home is a must see for every local family.

A few inviting features:

- Huge open plan living/dining on entry
- Excellent kitchen with electric cook top
- 20mm stone bench tops, breakfast bar

### SOLD | Contact Agent

**Contact:** Antonio Furfaro  
02 9755 4222  
0455 077 861  
Anthony Prestia  
02 9755 4222  
0414 775 577

**Type:** House

**Sold Date:** 09/08/2022

**Land:** 663.9m2

<https://www.realequity.com.au>



18 Whelan Avenue,  
Chipping Norton

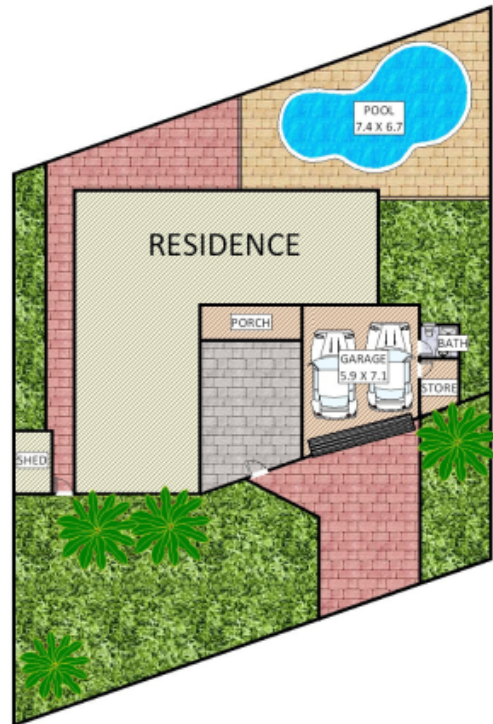

Disclaimer: Plans shown are for presentation purposes and are not part of any legal document. All measurements and figures are approximate. **HK FLOOR PLANS: 0455 905 945**

Plans shown are only indicative of layout. Dimensions are approximate.

**CHIPPING NORTON, NSW**  
18 Whelan Avenue