



## MOOREBANK, NSW

6 Kalana Place

**5** BED  
**3** BATH  
**2** CAR

**RealEquity**  
estate agents

A super spacious 5 bedroom family home with plenty of extra space for everyone to have their own space. Freshly painted and recently renovated, an ideal home for a large and growing family.

- New flooring throughout
- Freshly painted.
- Quiet street
- All bedrooms with wardrobes
- Main bathroom w spa bathtub & separate toilet
- Renovated bathroom

**\$LEASED**

**Contact:** Investment Management Team  
0297554222

**Type:** House

**Date Available:** 14/08/2022

**Leased Date:** 03/09/2022

<https://www.realequity.com.au>

**REAL EQUITY**  
estate agents

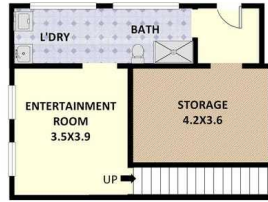
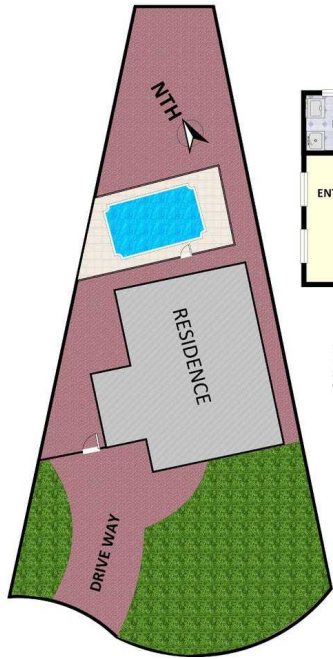

**BASEMENT**



**FIRST FLOOR**

Disclaimer: Plans shown are for representation purposes and are not part of any legal document. All measurements and figures are approximate.  
JORDAN FLOOR PLANS:  
0426400687



**GROUND FLOOR**

**6 Kalana Close,  
Moorebank**

Plans shown are only indicative of layout. Dimensions are approximate.

**MOOREBANK, NSW**  
6 Kalana Place