



**Wattle Grove, NSW**  
10A Tivoli Court

**4** BED **2** BATH **2** CAR



The first of its kind for the suburb and built to perfection, this extremely unique residence is a part of a stunning Torrens title triplex development that presents the opportunity for its new owner to enjoy a contemporary and convenient lifestyle in what could be one of the highest quality builds in Wattle Grove. The architects and builders have put together a very clever design with each residence offering the only common wall being the garage and the quality of construction is second to none with a combination of full brick, concrete slabs, contemporary cladding, pebblecrete driveways, and timber accents.

A Few Inviting Features:

**SOLD**  
**Contact:** Joshua Prestia  
 02 9755 4222  
 0404 252 695  
 Anthony Prestia  
 02 9755 4222  
 0414 775 577  
**Type:** Semi Detached  
**Sold Date:** 19/10/2022  
**Land:** 250.15m2  
<https://www.realequity.com.au>

Disclaimer: Plans shown are for presentation purposes and are not part of any legal document. All measurements and figures are approximate.  
JORDAN FLOOR PLANS: 0426400687

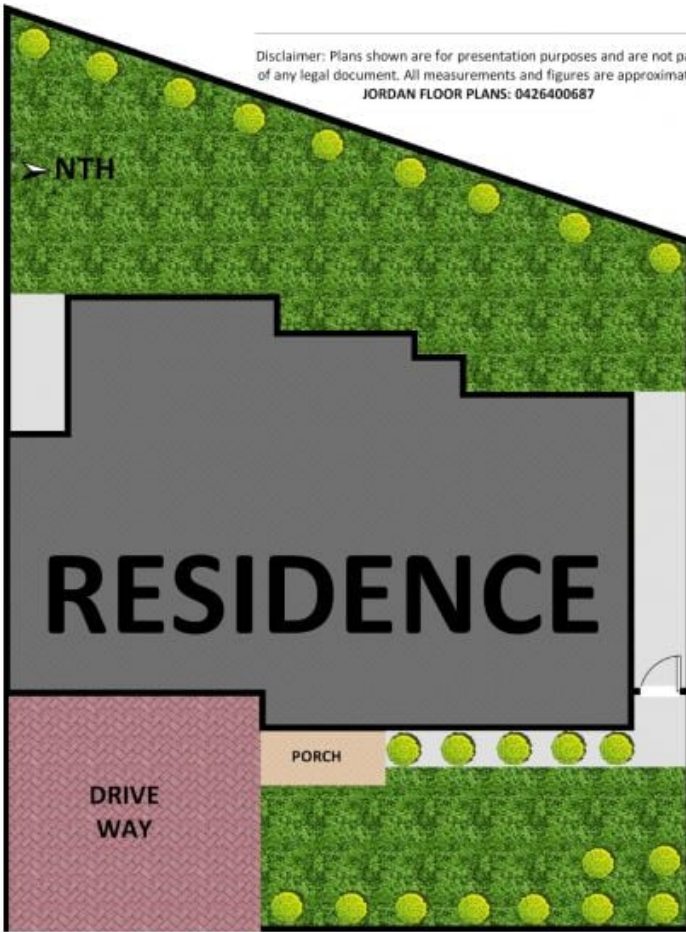

10C Tivoli court, Wattle Grove

**REAL  
EQUITY**  
estate agents



Plans shown are only indicative of layout. Dimensions are approximate.

**Wattle Grove, NSW**  
10A Tivoli Court