



Chipping Norton, NSW

1 Newham Place

4
BED

2
BATH

2
CAR

RealEquity
estate agents

SOLD

Contact:

Joshua Prestia
02 9755 4222
0404 252 695
Anthony Prestia
02 9755 4222
0414 775 577

Type:

House

Sold Date:

01/12/2022

Land:

371.3m2

<https://www.realequity.com.au>

With a commanding corner position, this impressive family home is beautifully designed inside and out complete with Spanish tiles, Italian marble and custom steel front door. Offering modern high-quality finishes throughout, lovely high ceilings combined with excellent entertainment spaces, and a low-maintenance lifestyle, this home presents elegant living at its finest.

A Few Inviting Features:

- Captivating facade with a lovely eastern aspect
- Foyer & spacious formal living room upon entry

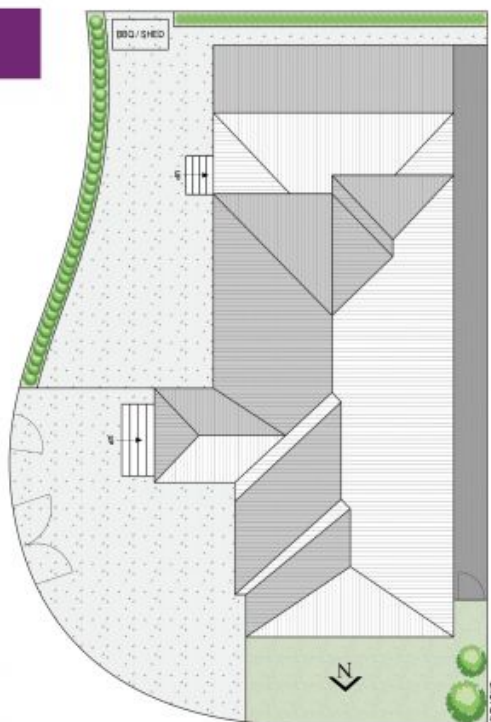

1 Newham Place, Chipping Norton

Internal Area (Approx.): 273.2m²
 External Area (Approx.): 21.5m²
 Land Size (Approx.): 669.0m²

Scale in metres. Indicative only. Dimensions are approximate. All information contained herein is gathered from sources we believe to be reliable. However we cannot guarantee its accuracy and interested persons should rely on their own enquiries.



Plans shown are only indicative of layout. Dimensions are approximate.

Chipping Norton, NSW
 1 Newham Place