



## Chipping Norton, NSW

1 Newham Place

**4**  
BED

**2**  
BATH

**2**  
CAR

**RealEquity**  
estate agents

With a commanding corner position, this impressive family home is beautifully designed inside and out complete with Spanish tiles, Italian marble and custom steel front door. Offering modern high-quality finishes throughout, lovely high ceilings combined with excellent entertainment spaces, and a low-maintenance lifestyle, this home presents elegant living at its finest.

#### A Few Inviting Features:

- Captivating facade with a lovely eastern aspect
- Foyer & spacious formal living room upon entry

#### **SOLD**

**Contact:** Joshua Prestia  
02 9755 4222  
0404 252 695  
Anthony Prestia  
02 9755 4222  
0414 775 577

**Type:** House

**Sold Date:** 01/12/2022

**Land:** 371.3m2

<https://www.realequity.com.au>

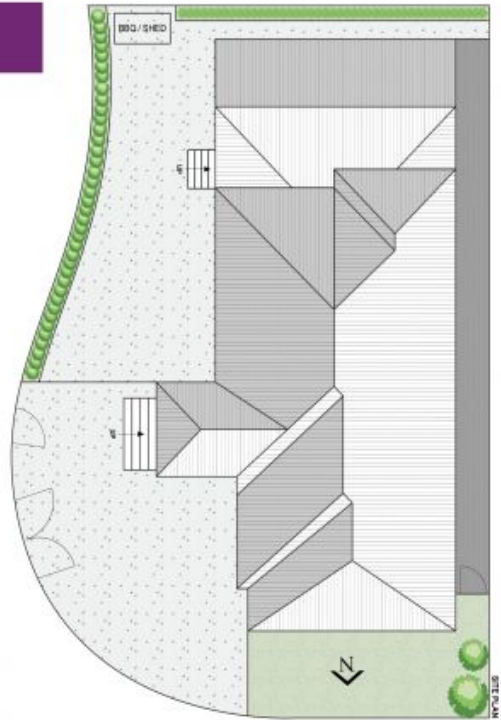

Internal Area (Approx.): 273.2m<sup>2</sup>  
 External Area (Approx.): 21.5m<sup>2</sup>  
 Land Size (Approx.): 669.0m<sup>2</sup>

## 1 Newham Place, Chipping Norton

Scale in metres. Indicative only. Dimensions are approximate. All information contained herein is gathered from sources we believe to be reliable. However we cannot guarantee its accuracy and interested persons should rely on their own enquiries



Plans shown are only indicative of layout. Dimensions are approximate.

**Chipping Norton, NSW**  
 1 Newham Place