



## Wattle Grove, NSW

3 Lomond Court

**4**  
BED

**2**  
BATH

**2**  
CAR

**RealEquity**  
estate agents

**\$1,390,000**

**Contact:**

Antonio Furfaro

02 9755 4222

0455 077 861

Joshua Prestia

02 9755 4222

0404 252 695

**Type:**

House

**Sold Date:**

07/06/2023

**Land:**

571m2

**<https://www.realequity.com.au>**

This stunning property has been completely renovated throughout, boasting a fresh and modern look that is sure to impress, but also offers the same character and charm from when it was built. The home is situated in a peaceful cul-de-sac location, providing a serene and tranquil living environment, and also conveniently located close to the Wattle Grove Lake, allowing for easy access to all the recreational activities it has to offer. Don't miss out on this incredible opportunity to call this renovated gem your own!

A Few Inviting Features:

- Large front yard with well-manicured gardens

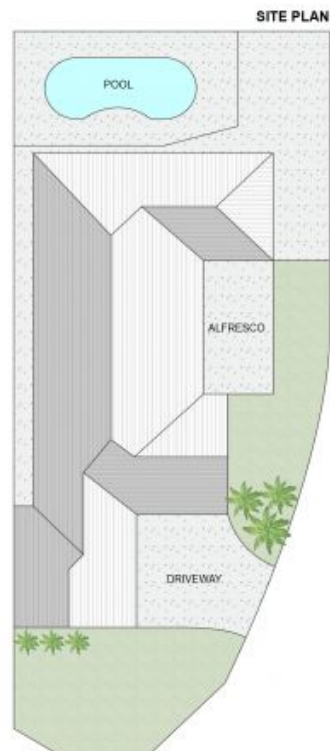

## 3 Lomond Court, Wattle Grove

Scale in metres. Indicative only. Dimensions are approximate. All information contained herein is gathered from sources we believe to be reliable. However we cannot guarantee its accuracy and interested persons should rely on their own enquiries.



Plans shown are only indicative of layout. Dimensions are approximate.

**Wattle Grove, NSW**  
3 Lomond Court

**REAL  
EQUITY**  
estate agents