



Wattle Grove, NSW

9 Merrang Court

3
BED

1
BATH

1
CAR

RealEquity
estate agents

UNDER OFFER

Contact: Antonio Furfaro
02 9755 4222
0455 077 861

Type: House

Land: 300m2

<https://www.realequity.com.au>

This inviting residence features sun-filled interiors and a spacious living area enhanced by its free-flowing floorplan. Boasting lovely outdoor entertaining spaces and a low-maintenance backyard, it is perfect for both relaxation and gatherings. With comfort and convenience in mind, this home is perfectly set for the family, or ideal for an investor seeking to add to their growing portfolio.

A Few Inviting Features:

- Spacious living extending to a lovely patio
- Open-plan family, dining & kitchen area

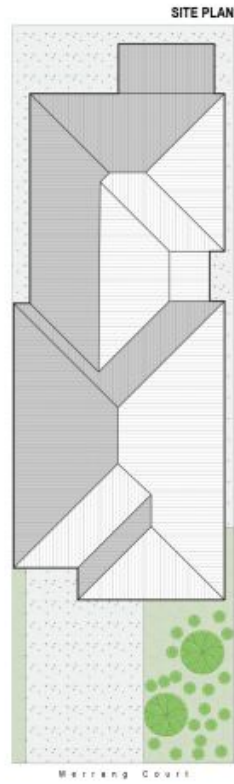

9 Merrang Court, Wattle Grove



Scale in metres. Indicative only. Dimensions are approximate. All information contained herein is gathered from sources we believe to be reliable. However we cannot guarantee its accuracy and interested persons should rely on their own enquiries.



Plans shown are only indicative of layout. Dimensions are approximate.

Wattle Grove, NSW
9 Merrang Court